



Surrounded by greenery but close to local amenities, a purpose built first floor apartment with a garage located at Oakwood, Greystoke Gardens in the ever popular suburb of Sandyford. Situated close to Jesmond Vale and Heaton Park, the apartment is also well placed for easy access to Heaton, the Ouseburn and on to Newcastle City Centre.

The accommodation briefly comprises: communal entrance hall; private entrance hall with four storage cupboards; 15ft lounge diner with dual aspect views; kitchen with fitted units and work surfaces; bathroom complete with three piece suite and storage cupboard; two bedrooms, both with west facing windows.

Externally, mature communal gardens and a garage providing off-street parking/storage. Offered to the market with no onward chain, early viewings are advised!

First Floor Apartment | Purpose Built Block | 781 Sq ft (72.5m2) | Two Bedrooms | 15ft Lounge Diner with Dual Aspect Windows | Kitchen | Bathroom | Garage | No Onward Chain | Leasehold - 55 Years Remaining (the lease extension is underway) | Service Charge £1,247.80 Per Annum | Council Tax Band A | EPC: C



1ST FLOOR
634 sq.ft. (58.9 sq.m.) approx.

GROUND FLOOR
146 sq.ft. (13.6 sq.m.) approx.

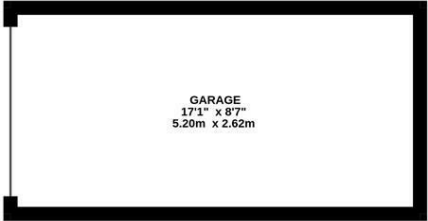
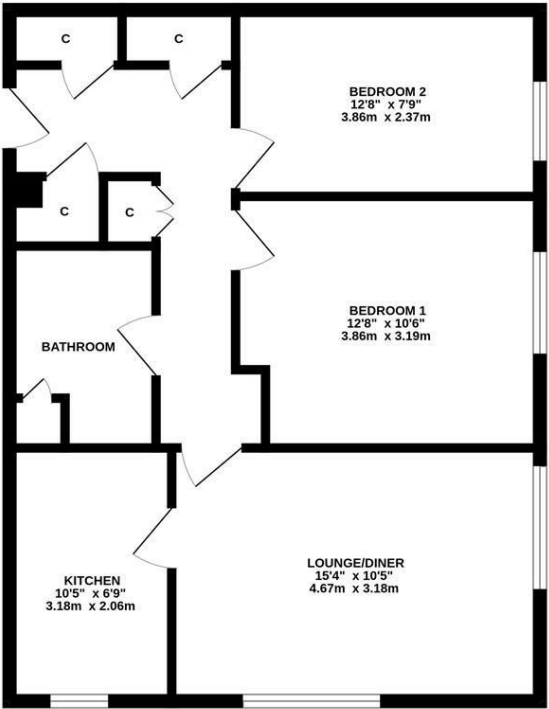

TOTAL FLOOR AREA : 781 sq.ft. (72.5 sq.m.) approx.

Whilst every attempt has been made to ensure the accuracy of the floorplan contained here, measurements of doors, windows, rooms and any other items are approximate and no responsibility is taken for any error, omission or mis-statement. This plan is for illustrative purposes only and should be used as such by any prospective purchaser. The services, systems and appliances shown have not been tested and no guarantee as to their operability or efficiency can be given.
Made with Metropix ©2025

Offers Over £120,000

IMPORTANT NOTE: These particulars and the descriptions and measurements herein do not constitute representation and whilst every effort has been made to ensure accuracy, this cannot be guaranteed.

